



ADJUSTABLE STEP 可調較金屬踏腳板

ADVANTAGES 優點

- Strong & durable design
堅固耐用
- Light and conventional
身輕及方便使用
- Four fixed adjustable angle
可調校四種角度
- Stable and safe
穩定和安全
- Non-slip & allows water to drain through
防滑並設疏水孔
- Quick angle adjustment
快速調校角度

Adjustable Step 可調較金屬踏腳板	Width, A	Step Width, B	Weight	Adjustable Angle	Safety Working Load	Factor of Safety
TCA-TAS6	715	600	4.4 kg	63° / 53° / 45° / 38°	200 kg	2.0
TCA-TAS8	915	800	5.1 kg			

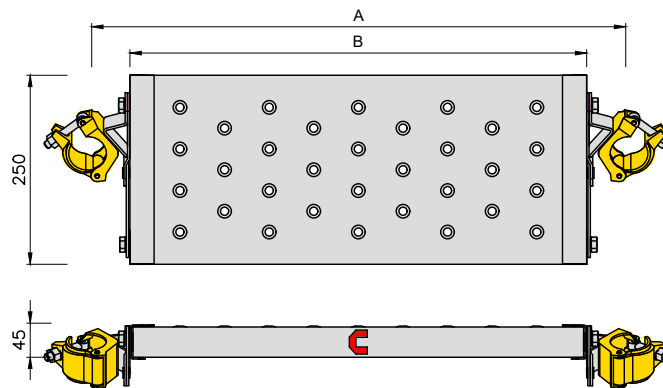

Instruction Video
使用說明視頻

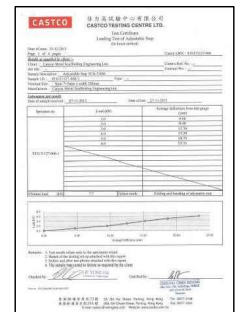
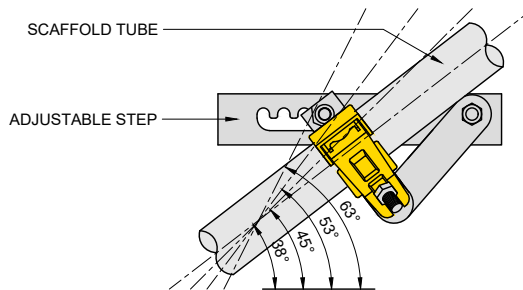
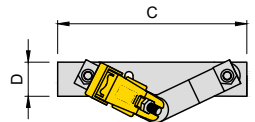

APPLICATION:

- Use for any slope works & external surface of terrain, and landscape slope.
- Convenient for erection of ladder / staircase for different lengths to accommodate various environment and locations.

